



# Ethernet<sup>®</sup> Interface for MicroLogix<sup>™</sup>

## Product Profile

The new 1761-NET-ENI provides EtherNet/IP connectivity for all MicroLogix controllers and other DF1™ full-duplex devices. The ENI allows users to easily connect MicroLogix onto new or existing Ethernet networks and upload/download programs, communicate between controllers, and generate Email messages via SMTP (simple mail transport protocol).

As with other MicroLogix communication devices, the ENI can be powered via the RS-232™ communications cable when attached to a MicroLogix controller, or externally with 24V dc when connected to other DF1 full duplex devices. It can be DIN-rail mounted, or panel mounted to meet virtually any installation requirement.

Feature	Benefit
Program upload/download	Upload or download user programs over Ethernet using the ENI. The only requirement is that you use RSLinx™ version 2.20 SP2 or newer.
Peer to Peer to communication	The ENI allows the attached controller to initiate or receive messages with other controllers. The controllers can be connected directly to Ethernet like the SLC 5/05™, PLC-5E™ or ControlLogix™ processors, or with other ENIs (MicroLogix, SLC 5/03™, CompactLogix™, etc.).
Email communication	The ENI enables a controller to send an ASCII string to an Email address. Send production data, alarms, or other status information to any computer, cell phone, or pager capable of receiving an Email message. This feature requires a valid SMTP Email server (Simple Mail Transport Protocol). SMTP servers are readily available via Internet Service Providers (ISPs).



Bringing Together Leading Brands in Industrial Automation

EtherNet /IP Compatibility	The ENI uses the open EtherNet /IP protocol. This industry standard open protocol provides inter device compatibility. The ENI can exchange information with other A-B Ethernet controllers (SLC™, PLC®, CompactLogix, FlexLogix™ and ControlLogix) in a peer-to-peer relationship, so you don't need any master type device.
Easy to Configure	The ENI can be configured via messages from the attached controller, or via the ENI utility. The ENI utility is a free Windows-based configuration package that is available from the MicroLogix website ( <a href="http://www.ab.com/micrologix">www.ab.com/micrologix</a> )
10 Base-T Port with embedded LEDs	Use any standard RJ Ethernet cable to connect to your network. This minimizes connection problems and improves startup. Embedded LEDs provide easy to see link and transmit/receive status.
Isolated Mini-DIN RS-232 Port	The RS-232 port provides isolation and will auto baud on power up to detect the communications port setting of the attached controller. Supported baud rates include 2400, 4800, 9600, 19.2k and 38.4k. This autobaud feature can also be disabled if desired.
Small and Compact	The ENI uses the same packaging as the AIC+ and DNI communication interfaces. This packaging is rugged and can be either panel or DIN rail mounted.

Technical Data	
10 Base-T (RJ45) Port	10M Hz
RS-232C Port	2400, 4800, 9600, 19.2k, 38.4k baud
Standards	IEC801-2, 3, 4, 5, 6
Power Consumption	100mA @ 24V dc
Temperature (operation / storage)	0 to 55°C / -40 to 85°C
Operating Humidity	55% to 95% non condensing
Standards and Regulatory Approvals	UL, C-UL, CE, Class I Div 2

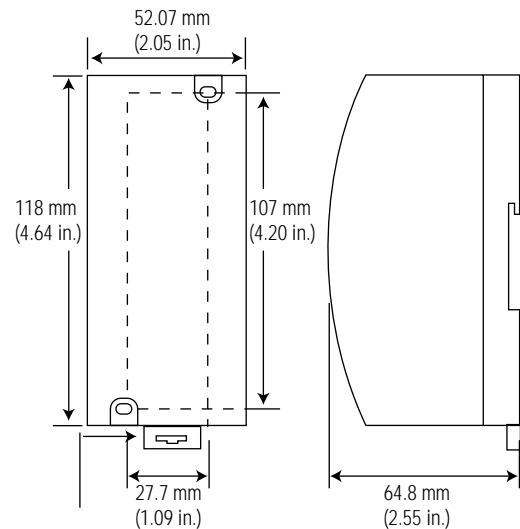

CompactLogix, ControlLogix, DF1, FlexLogix, MicroLogix, PLC, PLC-5E, RS-232, RSLinx, SLC, SLC 5/03 and SLC 5/05 are trademarks of Rockwell Automation. Ethernet is a registered trademark of Digital Equipment Corporation.

### Reach us now at [www.rockwellautomation.com](http://www.rockwellautomation.com)

Wherever you need us, Rockwell Automation brings together leading brands in industrial automation including Allen-Bradley controls, Reliance Electric power transmission products, Dodge mechanical power transmission components, and Rockwell Software. Rockwell Automation's unique, flexible approach to helping customers achieve a competitive advantage is supported by thousands of authorized partners, distributors and system integrators around the world.

**Americas Headquarters**, 1201 South Second Street, Milwaukee, WI 53201-2496, USA, Tel: (1) 414 382-2000, Fax: (1) 414-382-4444  
**European Headquarters SA/NV**, Boulevard du Souverain 36, 1170 Brussels, Belgium, Tel: (32) 2 663 0600, Fax: (32) 2 663 0640  
**Asia Pacific Headquarters**, 27/F Citicorp Centre, 18 Whitfield Road, Causeway Bay, Hong Kong, Tel: (852) 2887 4788, Fax: (852) 2508 1846

